

Technical Specifications Grand Hall



**The information in this document is subject to change without notice.*

The Grand Hall, located on Level 1, is the architectural heart of the Museum. Its glass façade, measuring 112 metres (365') long by 15 metres (50') high, offers a dazzling view of the Ottawa River and Parliament Hill. Along the opposite wall, there is a similar-sized colour photograph depicting a forest — thought to be the largest colour photograph in the world. Throughout the year, the Museum hosts all types of events, concerts, performances and banquets.

Hall Specifications

Maximum Capacity

- 600 banquet
- 600 theatre-style
- 1,000 standing concert

Control booth (sound, lighting and projection)

- A temporary control booth is set up 12.5 metres (41') from the front of the stage.

Internet Access

- The Hall is equipped with a continuous WIFI signal.
- A private WIFI line can be set up.
- Cabling can also be installed to provide Internet access.

Handicapped Access

- There are access ramps on both the left and right sides of the stage (see floorplan).

Service for the Hearing-Impaired

- Service for the hearing-impaired is available on the FM band, broadcasting a continuous signal.
- Receivers are available for use.

Green Room/Dressing Rooms

- There are 2 dressing rooms/washrooms able to accommodate 6–10 people. They are equipped with mirrors, couches, showers and toilets.
- The green room is equipped with couches, tables and two changing areas.

Stage

The stage is made of red cedar planks (softwood).

Width: 20.7 metres (68') Depth: 6.7 metres (25') (4.7 metres/15.5' to beak of totem pole) Height: 76 cm (30")

Dance floor and optional hard surface* are available upon request. (*Masonite®)

Equipment Specifications

The Hall has a range of permanent technical features. There is also a wide range of portable equipment that can be added, depending on availability and the type of event(s).

Sound

- Main speakers (ceiling): three curvilinear arrays (left, centre, right), each with 7 Meyer M1D powered speakers
- Secondary speakers (ceiling): two Meyer UPA-1P powered speakers
- Sub-woofers: four Meyer M1D powered speakers
- Processor: Meyer Galileo 408
- Audio cables: one 32-pair microphone cable and two 16-pair cables with 8 microphone lines and 8 return lines
- (1 stage left, 1 stage right)

Permanent Lighting

- Front of House (FOH): 24 x Strand SL 15-32 Zoom and 8 Martin MAC Quantum Profiles, Top lighting 6 Martin MAC Quantum Profiles

- Hall lighting: 12 x Strand SL 15-32 Zoom (It is also possible to control the architectural lighting from the lighting console.)
- Console Grand MA1
- DMX link between FOH and backstage
- PBS - pre-programmed stage lighting

Auxiliary Power Supply

- Backstage stage right: 1 x 200A 120V 3-phase Camlock
- Backstage stage left: 1 x 60A 120V (Appleton®)
- FOH: 1 x 200A 120V 3-phase Camlock

Communications System

- A complete ClearCom® system is available if required.

Événement / Event:

Date:

Code:

Cp:

Version:

Grande Galerie Grand Hall

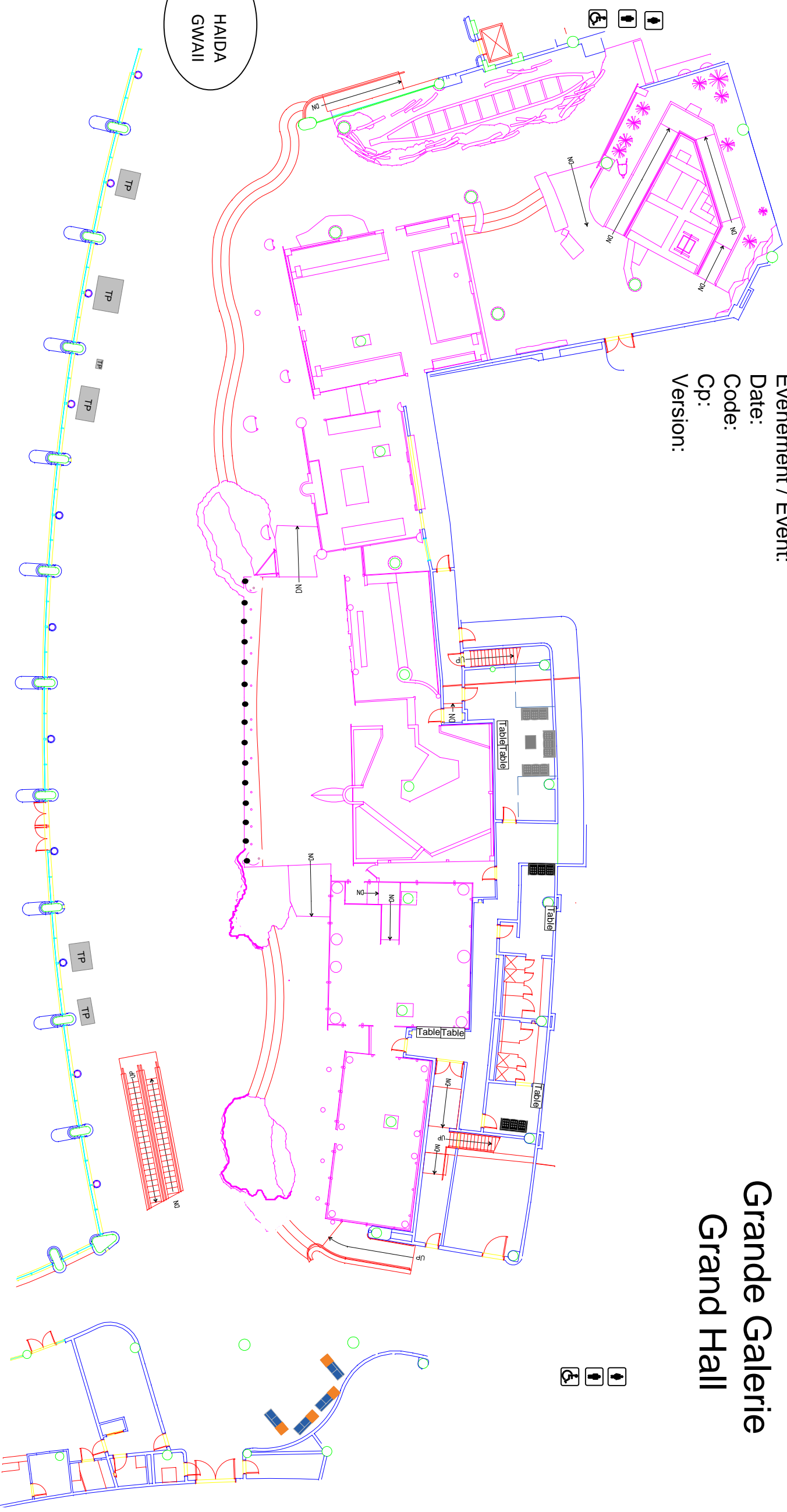

HAIDA
GWAII

